



# MARINE & FRESHWATER RESEARCH INSTITUTE

## Oceanographic and Fisheries Research Vessel



### Bjarni Sæmundsson RE-30



R/V Bjarni Sæmundsson was built in Germany. The vessel was delivered in December 1970 and went on her first cruise in January 1971. The vessel is built as a general research vessel, including fishery and oceanographic research. The propulsion system is of diesel electric type to secure low noise level. The vessels overall length is 56 m and breadth 10.6 m, height to upper deck is 7 m. The vessel is equipped with numerous winches and cranes.

R/v Bjarni Sæmundsson RE-30 / 1131:

IMO No.: 7017466  
 MMSI No.: 251199000  
 Call Sign: TFEA  
 ICES Shipcode: 46BS  
 Flag: Icelandic  
 Homeport: Reykjavik  
 Classification: Multi-Purpose Research Vessel  
 Building Year: 1970  
 Yard: Ssw Schichau Seebeck Shipyard, Germany

Main Dimensions:

Length o.a.: 55,87 m  
 Length p.p.: 49,00 m  
 Breadth mld.: 10,60 m  
 Depth to Trawl Deck: 7,00 m  
 Max Mean Draft: 4,00 m  
 Gross Tonnage: 822 tonnes  
 Cruising Speed: 12 knots  
 Range: 5000 nm  
 Accommodation: 13 Crew/13 Scientists

**Propulsion:**

The diesel electric propulsion system is based on three diesel engines and two tandem connected DC electrical motors.

**Engines:** 3x Deutz AG Werk Mannheim TBD 616 V12 585 kW @ 1500 rpm 400V/230V 50hz  
**Propulsion motor:** 2x515 kW @440 V  
**Propeller:** 2800 mm Diameter, max. 200 rpm  
**Thrusters:** 360° Bow Thruster Electrically Driven

**Electronics:**

The vessel is equipped with basic marine research and oceanographic equipment and is considered viable for silent ship operations.

**Echo sounders:** Simrad EK60 operating at three frequencies: 18,38 and 120 kHz  
**Fisheries Search Sonars:** Simrad SP70 Fisheries Sonar  
**Communication:** GMDSS, Internet through satellite and 3G



## Deck Equipment:

The vessel is equipped with numerous winches for towing and scientific purposes. Two main winches along with other winches such as, Gilson Winches, Outhaul, Cod End and Back Strap winches. The vessel has big drums for pelagic trawls or cables and a number of auxiliary winches. Scientific winches includes a hydrographic winch, a zooplankton winch, electrical cable winch and a multi purpose winch for various use. On board are three hydraulic cranes.

## Laboratories and Living Quarters:

The vessel is equipped with laboratories and research areas. Dry and wet laboratories, acoustic centre. Living quarters are suited for 13 crew and 13 scientists.

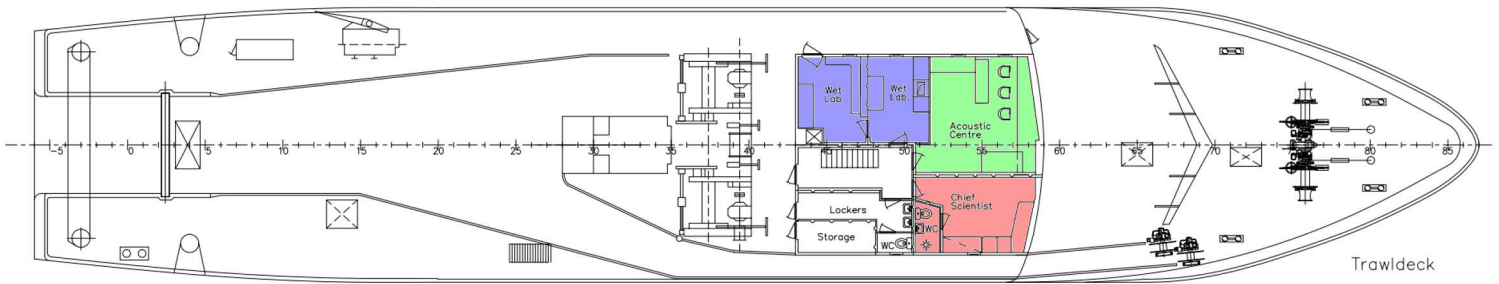

**Trawldeck:**  
Wet Laboratories  
Acoustic Centre

**Scientific Areas / Wet Laboratories**  
**Scientific Areas / Dry Laboratories**  
**Living Quarters / Common Rooms**

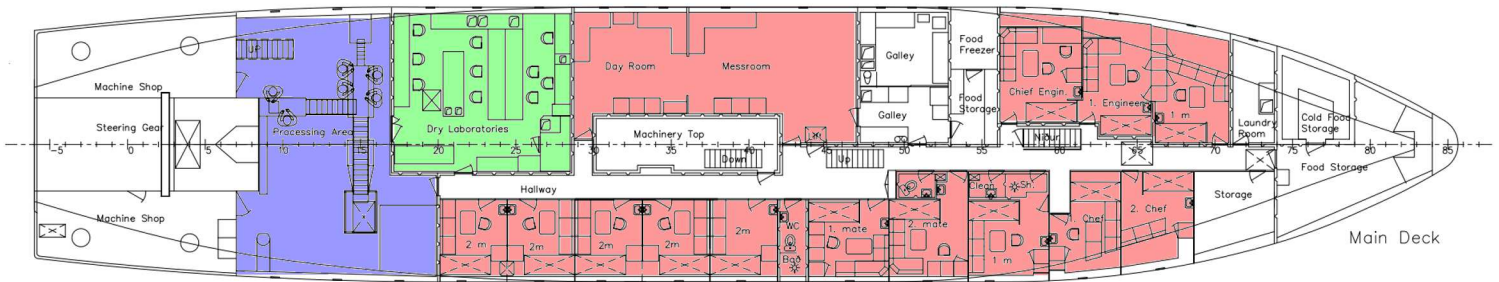

**Main Deck:**  
Processing Area  
Dry Laboratories  
Accommodation

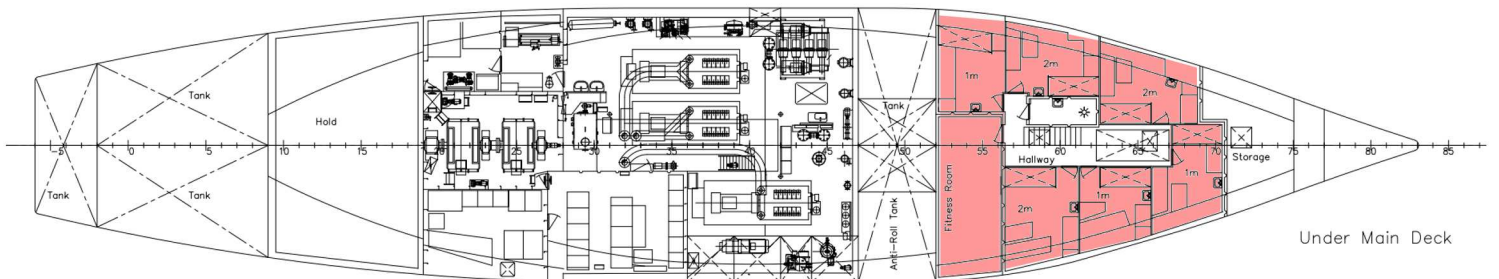

**Under Main Deck:**  
Hold  
Accommodation  
Fitness Room

